

# SML-multifunction manifold

SML-multifunction manifold is an assembly and supply manifold designed for Asco Numatics L2- and 551-valves.

Valve exhausts can be easily led out from a junction box with SML-multifunction manifold.

Individual shut-off in each output facilitates safe on-line service or modification with pressure on.

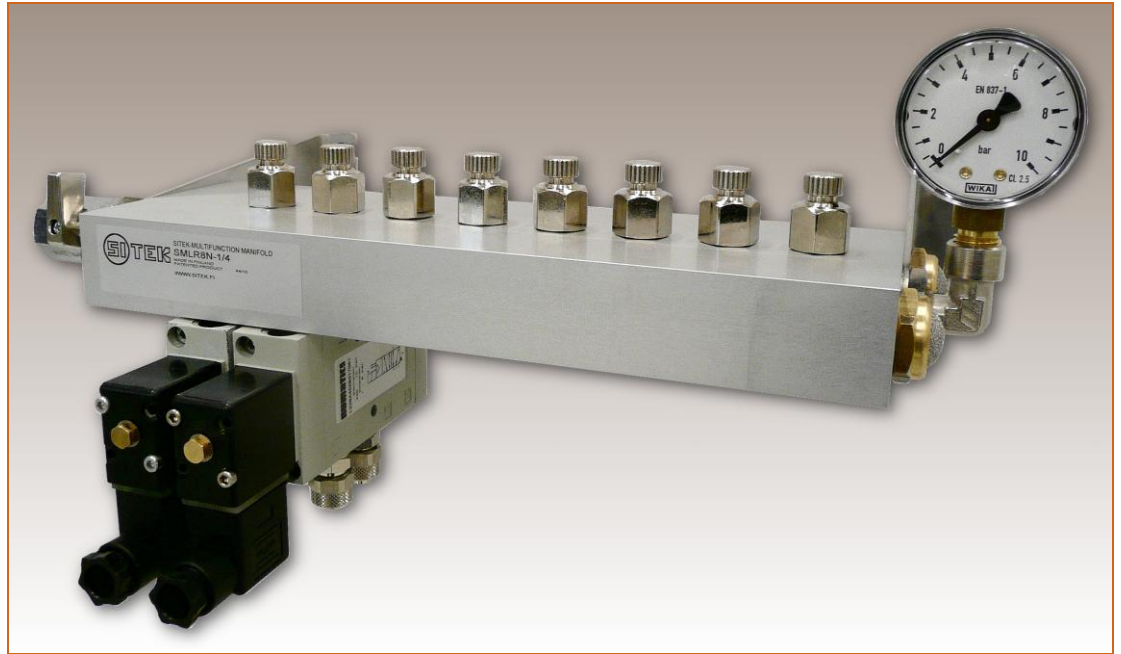

## TECHNICAL DATA

Suitable fluids	Dry or lubricated air or gas
Input	1/2" R/G or NPT
Outputs	1/4", 3/8", R/G or NPT
Number of outputs	6, 8, 12
Temperature range	- 20 ... + 90 ° C
Operating pressure	Vacuum ... 16 bar (232 psi)
Material	Anodised aluminium and nickel plated brass

Standard construction: individual shut-off valves, brackets, double nibble and end cap. End thread is always 1/2".

Manifold with NPT-thread: the character R on types shall be replaced with N, bracket height is 120 mm.

Manifold can also have laser position marking.

## TYPE CODE

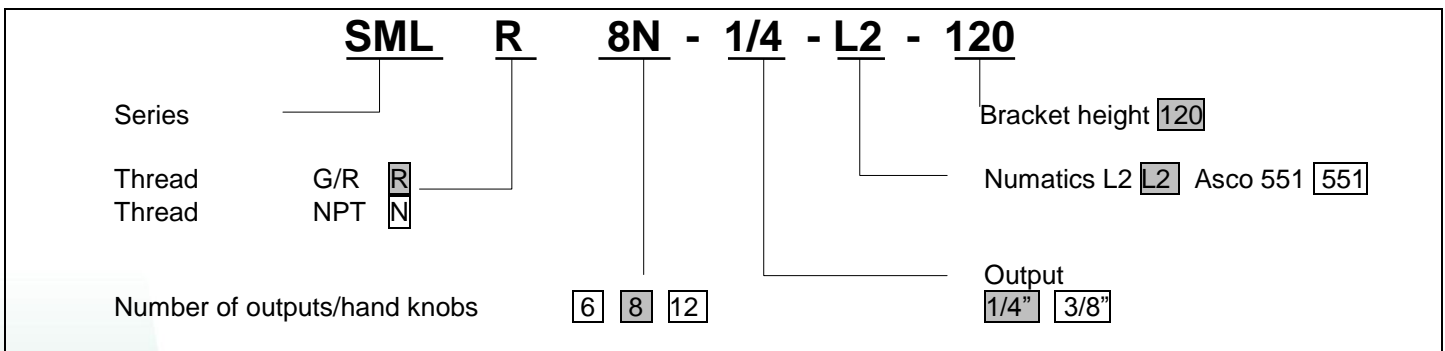

Example: Multifunction Manifold **SML**, **R**-thread, **8** outputs/hand knob **N**, **1/4"** output thread, for Numatics **L2**-valve, bracket height **120** mm



Sitek-Service Ltd

Laukaantie 4

Hatanpäänvaltatie 34 A

E-mail: [sitek@sitek.fi](mailto:sitek@sitek.fi)

40320 Jyväskylä

33100 Tampere

[www.sitek.fi](http://www.sitek.fi)

Tel. +358 14 337 2300

Tel. +358 03 265 4069

# Dimensions

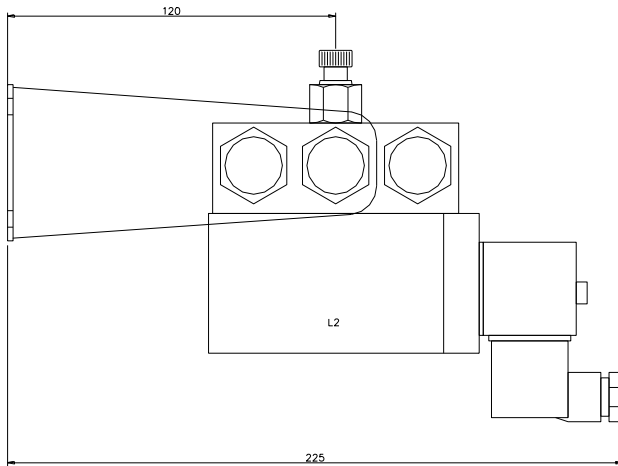
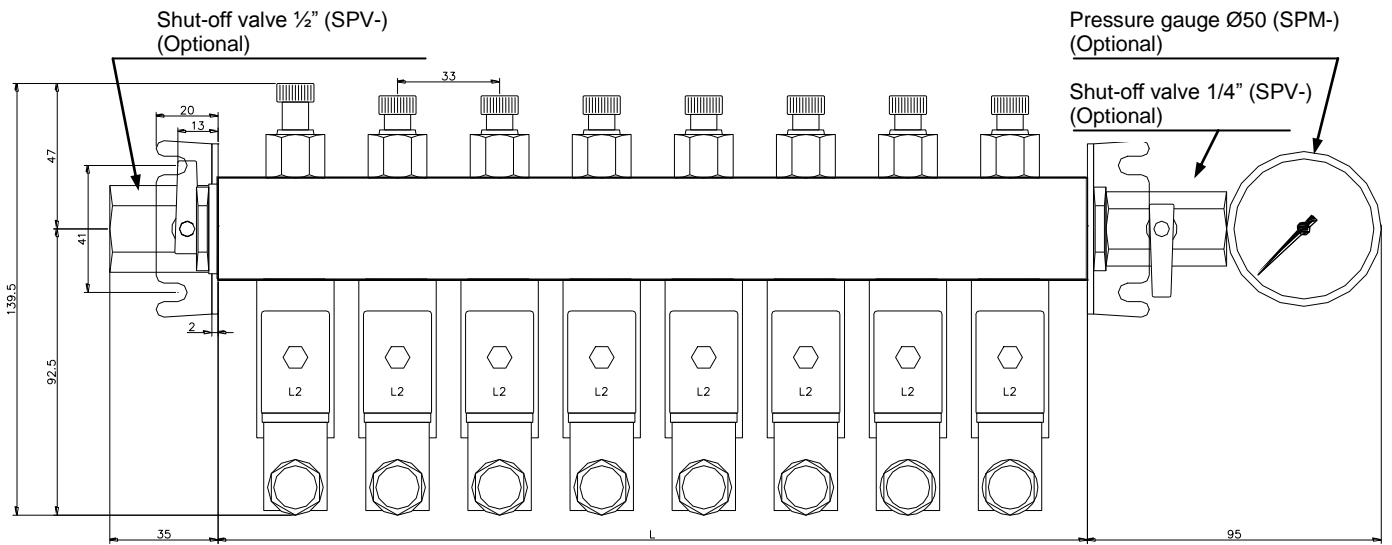

DIMENSIONS			
Outputs	6	8	12
Length L/mm	215	281	413
Spacing E/mm	33	33	33

## DEVICE MOUNTING

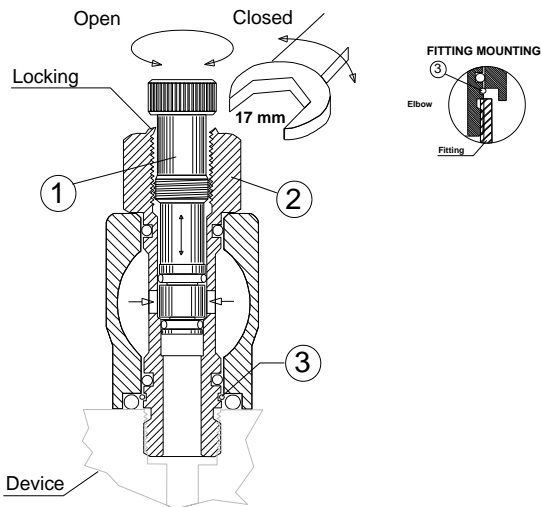

## USING THE OUTPUT PORT

1. The Shut-Off Stem must be closed (lower position) when connecting or removing equipment.
2. Turn the Assembly Bolt to install or remove equipment.
3. The Locking Ring will lock the Assembly Bolt. No extra plugs are needed.
4. The Fitting must be tightened slightly towards the elbow. This allows free rotation of the assembly and prevents the tube from being bent.

Seal the Fitting with glue (O-ring does not work as sealing in this case).

Do not tighten too heavy, the Fitting will not tighten itself against the manifold body (elbow damage).

**Warning: Maximum tightening torque for assembly bolt 30 Nm ( 3 kpm )**